



**TEACHING & LEARNING  
SYMPOSIUM 2023**  
Saginaw Valley State University **February 17**

***Creating Flexible  
Learning Environments:***

***Universal Design for Learning  
and Equity in Higher Education***





# THE CENTER FOR EXCELLENCE IN *TEACHING & LEARNING*

**Erik Trump**

*Acting Director,  
Center for Excellence in Teaching & Learning*

**Brittany Collins**

*Assistant Professor, Dept. of Communication  
CETL Faculty Fellow*

**Michael Coote**

*Associate Professor, Dept. of Chemistry  
CETL Faculty Fellow*

**Anne Huebel**

*CETL Online/Hybrid Support Specialist,  
& Instructional Designer*

**Kim Lacey**

*Associate Professor, Dept. of English  
Writing Program Administrator*

**Deb Rickert**

*CETL Office Coordinator*

**INNOVATE**

**COLLABORATE**

**CONNECT**

---



**W**elcome to the Center for Excellence in Teaching and Learning's (CETL's) ninth annual Teaching and Learning Symposium. The theme for this year's symposium emerges from a growing interest in making higher education more accessible and inclusive. Several years ago, SVSU's student body identified ways that our campus could be more welcoming to students from all backgrounds, and the shift to online teaching during the pandemic raised new awareness about how to make course design and instructional practices universally accessible. Committees and individuals across campus have started the project of raising awareness about Universal Design for Learning (UDL) and diversity, equity, and inclusion (DEI) issues, and the 2023 symposium represents an additional step in moving the campus closer to the goal of providing an educational experience that supports the most students possible.

In its design, this year's symposium embraces two goals: to offer a larger number of shorter learning opportunities, and to emphasize hands-on and faculty-driven activities. In short – less being talked to, and more doing and conversation. In the first workshop, participants will write autobiographies that support an inclusive classroom; in the second workshop, they will develop UDL teaching methods for three areas. In the afternoon, attendees can choose from a menu of rotating workshops on UDL, DEI, career preparation, active learning, Canvas accessibility, and CETL grants.

As always, the symposium also celebrates the innovative and exceptional teaching practices of SVSU faculty. Over the past eight years, over 45 faculty have received Dow Professor awards to fund innovative teaching, while eleven departments have used the Department Innovation grant to support student success projects. Several dozen faculty have developed Open Educational Resources to significantly reduce students' textbook costs. Scores of SVSU faculty have made presentations or conducted workshops at Teaching Tables, Faculty Fridays, and the annual Symposium. Many others have served as mentors, sat on CETL committees, or participated in Faculty Learning Communities. In the pages that follow, we briefly profile everyone who has been engaged in CETL-related activities during the 2022-23 academic years. In today's activities, many of those same folks will be leading workshops – please find some time to thank them.

We hope that the symposium will inspire new and continued involvement in SVSU's teaching and learning community. If you have ideas for CETL programming, please share them. If you'd like to apply for a grant or join a formal Faculty Learning Community, let us help you. If you'd like an individual consultation to improve a course or learn a new teaching method, contact us. If you'd just like some coffee and conversation, drop by our office.

***- The CETL Team***

# PROGRAM

**9:00 - Breakfast**

**9:30 - Welcome** *Deb Huntley*

**9:40 - Introduction** *Erik Trump*

**10:00 - Creating Stories to Create Connectedness and Community**

*Brittany Collins with Grace McClurkin, Rajani Muraleedharan, and Poonam Dharam*

First-generation college students often face challenges with a sense of belonging and feeling connected to their college or university community. In this workshop, participants will learn more about the power of storytelling by working to create strategic, personal autobiographies - autobiographies designed specifically with the aim of creating a more inclusive classroom community.

**11:00 - Inclusive Instructional Design**

*Michael Coote with Aneesa Gogineni, and Marilyn Tourne*

Unleash the full potential of more learners with our Universal Design for Learning (UDL) workshop. Emphasizing three UDL principles -- engagement, representation, action and expression -- this workshop will expand the tools and strategies you use to cater to students' diverse learning needs. We will break into three groups, with each group exploring a different facet of UDL from multiple disciplinary perspectives. The workshop aims to increase your awareness about the many ways instructional techniques can be made more flexible, accessible, and effective.

**12:00 - Lunch & Dow Professor and Department Innovation Grants video**

**1:00 - Break-out room workshops (35 minutes each)**

Room	1:00	1:45	2:25
C 220	DEI Resources	DEI Who's in Class	DEI Discussion
C 222	UDL Engagement	UDL Representation	UDL Action
C 223	Career Preparedness	Career Preparedness	Career Preparedness
Seminar G	Active Learning	Active Learning	Active Learning

**1:00-2:00 Canvas Accessibility** (*C 141*)

**1:30-1:45 CETL Grants** (*Seminar D*)

**2:15-2:30 CETL Grants** (*Seminar D*)

**3:00 Wrap up** (*Seminar D*)

## **Career Preparedness and Academic Programs**

*Joe Weaver*

One measure of “student success” is students’ preparation for careers, and increasingly, students choose majors with an eye to career outcomes. What can we do at the classroom, program, and university levels to support students’ career preparedness? Please join a conversation with members of a Faculty Learning Community focused on this question and receive some implementable resources. Bring your suggestions, questions, and observations. We would love to hear from faculty who put career preparation at the center of their instruction, as well as from those for whom “career” rarely appears in the classroom context.

## **Less Lecture, More Active Learning**

*Aneesha Gogineni, John Herman, Peggy Jones, and Monayem Mazumder*

How best to teach how a composite material fractures under stress? Lecture? Textbook? Video demonstration? What about combining some of those methods with a hands-on active learning activity involving a Rice Krispie Treat? Join members of the Mechanical Engineering department for a hands-on session where you can test (and eat) some of their active learning props and brainstorm active learning activities for your own courses. How, for example, might a political scientist teach the “veil of ignorance” with physical props, or a sociologist teach “social capital” with a hands-on activity? Are you up for the challenge? Rice Krispie Treats provided!

## **Canvas Accessibility**

*Anne Huebel, and Cindy Patterson*

How accessible is your Canvas course? Drop in and find out! Anne and Cindy will help you learn how to use the “accessibility checker” and create fixes for problems it identifies. They will also suggest course design principles that can make your Canvas course easier for students to navigate and use.

## **The Inclusive Classroom**

*Brittany Collins, Veronika Drake, and Emily Beard-Bohn*

Join an interactive and collaborative exploration of inclusive teaching practices and the inclusive classroom. In the first session, extend this morning’s conversation with Brittany and learn about resources for your classroom. Next, Veronika’s inclusion-focused FLC members will teach you how to use the “Who’s In Class” form to learn more about your students’ backgrounds, perspectives, and social identities. Join Emily’s FLC in the final session to discuss how a range of inclusion-related questions and concepts might impact your teaching practices.

## **Universal Design for Learning in Practice**

*Michael Coote, Aneesha Gogineni, and Marilyn Tourne*

Perhaps UDL should be renamed GTP (Good Teaching Practices). Do you have UDL practices that colleagues from other disciplines might be able to adapt or adopt? Questions about the concept? Ideas for future CETL programming? Please join Michael, Aneesha, and Marilyn to continue and extend this morning’s conversation.

## **CETL Grants: Dow Professor, Department Innovation, Rural Pathways, and Faculty Learning Communities**

*Erik Trump*

Have an idea for a course or program innovation that would support student success? Interested in forming a community with colleagues to discuss a teaching topic of mutual interest and apply what you learn in your own classroom? Please join Erik to review the application process, discuss your project ideas, and find out how CETL can support you. Get your hands on a grant application and make a start!

# Dow Professor Grant Recipients

*Funding for these projects was provided by the Herbert H. and Grace A. Dow Foundation.*

## Exploring, Developing, and Implementing Evidence-Based Pedagogical Practices for First-Generation College Students



*Brittany Collins, Assistant Professor of Communication*

I specialize in organizational communication and leadership. As a CETL Faculty Fellow, I have been examining how students from various backgrounds, experiences, and identity groups adjust to university life. I am particularly excited about sharing activities that fellow faculty can use to help first-generation students feel a greater sense of belonging, connectedness, and community within our classrooms

### **Abstract**

With growing attention around issues of diversity on college campuses, it is imperative to focus on developing better practices for groups who may experience challenges – particularly those who face such challenges because of their difference(s). First-generation students comprise one of those groups. For many first-generation students, certain challenges in the matriculation process continue to plague their experiences (see Beresin and Watkins, 2022). The purpose of this project is to better serve first-generation students by gathering evidence-based, expert-informed resources that can further develop with two goals: (1) implementing resources into introductory courses; and (2) sharing resources with colleagues who also seek to better serve first-generation students. To accomplish the abovementioned goals, I intend to use the funds to attend the 29th National Conference on Students in Transition.

## Archaeological Excavation Experiential Learning

### *Rosina Hassoun, Associate Professor of Anthropology, Sociology*

Rosina Hassoun seeks to engage her students in real-world research and other experiential learning opportunities. For example, she has mentored a student whose Flint water crisis-related research developed into an ongoing research component for students in her Sociology of Medicine course. This past fall semester, students in her Physical Anthropology and Archaeology course took the first steps in excavating a Davis farm site on campus.



### *Brad Jarvis, Associate Professor of History*

A professor of history, Brad Jarvis has long been committed to providing experiential learning opportunities for students. He helped develop a public history minor for his department, and he has mentored students in family history-writing projects. A winner of the Innovative Writing in Teaching Award, Brad teaches and researches Native American and Great Lakes history.



### *Kenneth Jolly, Professor of History*

Kenneth Jolly is a Professor of History and the Coordinator for the Black Studies program at SVSU. His research examines Black Liberation movements, and he teaches courses in Black Studies, African American History, the Black Power and Civil Rights Movements, the History of the African Diaspora, and U.S. History.



### *Rhett Mohler, Professor of Geography*

Rhett Mohler is a Professor of Geography. He enjoys teaching both general education and upper-level courses in the Geography Department. He also likes to involve students in research. His work primarily revolves around the use of uncrewed aerial vehicles, commonly called drones, to study landscape changes, particularly as they pertain to



## Abstract

The proposed archaeological dig is to uncover evidence of 19th Century agriculture, a drainage site belonging to the Davis family farms, and/or possible Native American on the property of Saginaw Valley State University. The excavation is designed to provide experiential learning for history and anthropology/sociology students enrolled in classes on campus, as well as develop a potential site for campus educational visits for local school students and local community members. The project is in conjunction with the Castle Museum which will supply the display and archival space and archaeological expertise. The project will hopefully provide recruitment and community engagement possibilities, as the local history is explored while leaving a legacy for the Kochville community.

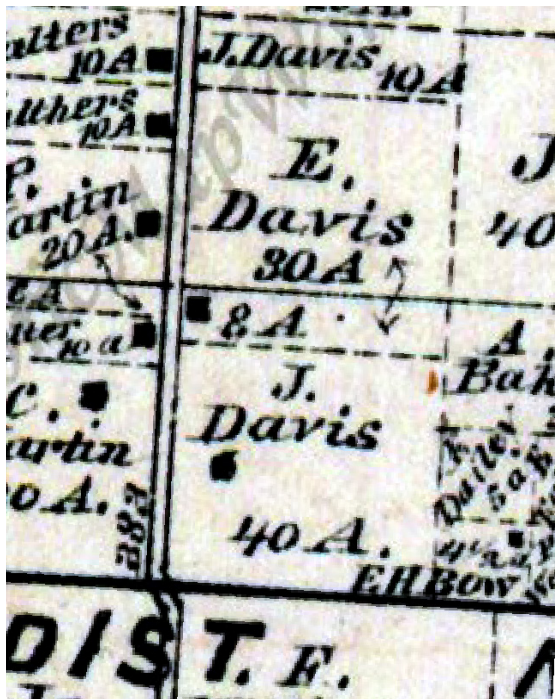



# Department Grant Recipients

## Formative Assessment: Evaluating Ongoing Student Learning

***Catherine A. Macomber, PhD, LMSW, Chair and BSW Program Director, Department of Social Work & Youth Services***

Catherine A. Macomber is a Licensed Social Worker with a PhD and Master's degree in Social Work and a Certificate in Public Health from Michigan State University. She has expertise in interprofessional ethics, curriculum design, research, and policy, and has used this with Federal and State grant funded programs.



### **Abstract**

The project targets undergraduate social work majors. The Bachelor of Social Work program at SVSU is an accredited program. Our accrediting body requires two assessments annually of student progress toward nine competencies. Our current formative assessment is inadequate and cumbersome. This project will engage the services of an outside formative assessment expert to develop and pilot a new formative assessment for the undergraduate social work program. The new assessment will be evaluated using a rubric developed in conjunction with the development of the assessment itself. In addition, focus groups will be engaged following the pilot to assess the assessment and make needed changes prior to implementation of the final version. Funding will be used to contract the formative assessment expert as well as to incentivize participation in the focus group evaluation.

# Psychology Career-Readiness Initiative



*Julie Lynch, Associate Professor, Lead Faculty Member*

Julie Lynch has been a faculty member in the SVSU Psychology Department since 2002. She specializes in educational and developmental psychology, with research focusing on the development of reading and writing skills. She enjoys mentoring students as they explore psychological research and career paths.

## Abstract

The goal of this project is to expand and strengthen the department's internship program as well as offer other career-related opportunities. The initiative will primarily impact psychology majors, helping them to develop marketable skills and explore potential long-term career paths. We also aim to develop meaningful partnerships with organizations in the Great Lakes Bay region, strengthening both the university and the surrounding communities. We will hire a student assistant to manage many day-to-day tasks, allowing faculty members to focus on building personal relationships with community partners and envision future directions for the program. With grant resources, we plan to increase enrollment in our internship course and expand experiential learning options more generally.



# Faculty Learning Communities

## The Career Preparation Faculty Learning Community

*The Career Preparation Faculty Learning Community is the result of a partnership between CETL and Career Services. Members of this FLC are working with Career Services to develop methods that will engage students in curricular or co-curricular activities to promote career success.*



**Jadallah Jadallah**  
*Assistant Professor of Accounting*

Jadallah Jadallah is an Assistant Professor of Accounting. He received his bachelor's degree from John Carroll University, his master's degree from Case Western Reserve University, and his Ph.D. from Kent State University. Dr. Jadallah facilitates student participation in his classes. His research focuses on financial accounting restatements.

**Cal Borden**  
*Associate Professor of Biology*

I arrived in 2014 after failing to avoid a real job. Since then, I've led 11 courses from non-majors to upper-level electives in which I witnessed an astonishing range of student preparedness for university rigors. This sense of helplessness led me to the FLC-Career Preparedness Group as a therapeutic outlet.





***Jill Waliczek***  
***Assistant Professor of Educational Leadership  
and Services***

Jill Waliczek has been in public education for 17 years serving as both an elementary teacher and school principal. She obtained her Ed.D. from Michigan State University (Go Green!) in March of 2020 and joined the faculty at SVSU in January of 2022 serving in the Educational Leadership and Services program.

Jill is a 2017 Alumna and still active member of the SVSU Gerstacker Fellowship Leadership Program. She is also currently a Michigan Education Policy Fellow.

***Babak Lotfaliei***  
***Assistant Professor of Finance***

I joined SVSU in 2021. I research how firms default and markets evaluate their creditworthiness in bond markets. This enables me to teach students about how to make investments and corporate financial decisions. I use applied teaching techniques such as case studies. I also enjoy writing case studies for students and coaching them in finance competitions.



***Margot Alvey***  
***Assistant Professor of Medical Laboratory  
Science***

Margot Alvey is the Program Director and Assistant Professor for Medical Laboratory Science. She earned both her bachelor's and master's degrees at SVSU. Her technical lab expertise is in clinical hematology and chemistry. She hopes to enhance experiential learning in the program through simulation, interprofessional education, and workshops.



**David Berry**  
*Professor of Kinesiology*

Dr. David C. Berry is a licensed athletic trainer with 25 years of clinical-based practice and higher education experience. As a Professor of Kinesiology at Saginaw Valley State University, Dr. Berry teaches injury assessment, therapeutic modalities, and emergency response management courses. He has published, lectured, and developed workshops at the state, regional, and national levels for athletic trainers and other healthcare professionals on numerous topics, including emergency trauma management, aquatic therapy, and healthcare leadership.



**Peggy Jones**  
*Assistant Professor of Mechanical Engineering*

Peggy Jones is an Assistant Professor of Mechanical Engineering. She earned her bachelor's degree from the University of Michigan and completed her M.S. and Ph.D. in Materials Science and Engineering at the University of Dayton. She joined SVSU in 2019 after 38 years of industry experience. She enjoys creating "hands-on" learning activities and developing critical thinking skills in the next generation of engineers.



**Christopher Nakamura**  
*Associate Professor of Physics*

Chris Nakamura joined SVSU Physics in Fall 2012. His teaching interests include introductory calculus-based physics and upper-division physics. His research interests connect Physics Education Research (PER) and Atomic, Molecular and Optical (AMO) physics. He earned his undergraduate degree at the University of Michigan and graduate degrees (MS, PhD) from Kansas State University.





***Joe Weaver***  
*Associate Professor of Psychology*

Joe Weaver has been researching and teaching at SVSU since 2016. He hopes to help students discover the relevance and utility of the courses he teaches and enjoys trying new approaches to engage students. He has served as a CETL Teaching Fellow and is currently facilitating the Career Preparedness FLC.

***Ashley Sanders***  
*Assistant Professor of Social Work*

Ashley Sanders is an Assistant Professor of Social Work. She is an SVSU alumna, earning her Bachelor of Psychology and Bachelor of Social Work from SVSU. Recently, she graduated with her Doctorate from Liberty University. She strives to create a stimulating environment where students can grow academically, emotionally, and socially.



***Tommy Wedge***  
*Assistant Professor of Theatre*



Tommy Wedge has been active in teaching, directing, and stage combat. He is the recipient of three Open Education Resource Grants. His current creative project is directing Caryl Churchill's play *Top Girls* which runs April 6-10 at SVSU.

## The Mid-Career/Senior Faculty Learning Community

*The Mid-Career/Senior Faculty Learning Community, in partnership with the Office of Diversity Programs, is focused on examining the impact of diversity, equity and inclusion on teaching. These FLC members are developing projects to ensure that all students feel welcomed and valued in their academic spaces.*

### **Brittany Collins** *Assistant Professor of Communication*

I am an Assistant Professor of Communication, specializing in organizational communication and leadership and communication. As a CETL Faculty Fellow, I have been examining how students from various backgrounds, experiences, and identity groups adjust to university life. At today's symposium, I am particularly excited about sharing activities – such as an "Autobiography" – that fellow faculty can use to help first-generation students feel a greater sense of belonging, connectedness, and community within our classrooms.



### **Veronika Drake** *Assistant Professor of Theatre*

Veronika Drake is an Associate Professor of English. She loves all things language and teaches linguistics courses, trying to raise students' awareness about linguistic bias and discrimination. Her research focuses on linguistic formats such as or-final questions (Are you gonna go out or..) and their interactional functions.



### **Emily Beard-Bohn** *Associate Professor of English*

Dr. Emily J. Beard-Bohn is an Associate Professor of English. She has been teaching at SVSU for 12 years. Dr. Beard has been fortunate to teach for the English department, the Rhetoric and Professional Writing department, and the Honors Program. In addition to teaching first-year students, she teaches Censorship, Media Bias, and Fake News classes and courses on the Pursuit of Happiness. Her research examines the implications of human evaluators vs computer evaluators on writing placement exams.





***Melissa Garmo***  
***Associate Professor of Criminal Justice***

Dr. Melissa Garmo is an Associate Professor of Criminal Justice. She has been teaching at SVSU since 2009 and served as Chair of the Criminal Justice Department from 2018-2022. Dr. Garmo's teaching interests focus on inequalities in the Criminal Justice System, including classes such as Social Justice, Wrongful Convictions, and Gender & Crime. Dr. Garmo works with the campus community as well as local community organizations to provide training and resources about diversity, equity, and inclusion.

***Kimberly Lacey***  
***Associate Professor of English***

Kim Lacey (she/her) is an Associate Professor of English and has been at SVSU since 2011. Dr. Lacey's work has appeared in *Rhetoric Society Quarterly*, *Configurations*, *Journal of Evolution and Technology*, and other journals. Her manuscript, *Creative Futures: Robot Picassos, Fake Friends, and Other Sneaky Ways Technology Acts Creatively*, is under contract with Lexington Books.



***Annamalai Pandian***  
***Professor of Mechanical Engineering***

Annamalai Pandian is a Professor of Mechanical Engineering and Program Director for the B.S. in Engineering Technology Management program. He has more than 15 years of professional experience in automotive tooling design, manufacturing, project management, and quality control. He has taught Engineering Mechanics, Statics & Dynamics, CAD, Jigs & Fixtures, Lean Manufacturing, Quality, Robotics & Machine Vision, Manufacturing Process Engineering, and Manufacturing Systems Design and Simulation. He is also a member of the editorial advisory board for the *International Journal of Quality and Reliability Management* and winner of the outstanding faculty scholarship award.





***Aricka Schweitzer***  
***Associate Professor of Occupational Therapy***

Aricka Schweitzer is an Associate Professor of Occupational Therapy and directs the Master of Science in Occupational Therapy program at SVSU. Dr. Schweitzer received her Doctorate in Education with a specialization in Higher Education Leadership in 2019, her Master of Science in Occupational Therapy in 2009, and her Certification in Neuro-developmental treatment from the Neuro-developmental Treatment Association (NDTA) in 2011. She has presented at the local, state, and national level with a focus on the Scholarship of Teaching and Learning (SoTL), teaching in higher education, and teaching occupational therapy.



***James Hitt***  
***Associate Professor of Philosophy***

Hired in 2009, it has been a wonderful ride so far. I was hired, who really knows why, because of my experience with medical ethics. The bulk of my teaching, writing, and community work surrounds bioethics. When I teach well, I learn too. Not so much for death.



***Mark Giesler***  
***Professor of Social Work***

Mark A. Giesler, Professor of Social Work, has been at SVSU since 2006. His research agenda includes qualitative studies of marginalized groups, including LGBT individuals and homeless populations, and most recently, studies of the intersection of public libraries and social work. He is currently an Assistant Editor for the *Journal of Ethnographic and Qualitative Research*. In addition to his work in academia, he works part-time as a private practice therapist for Butterfly Counseling in Ypsilanti, Michigan.



**Anne Tapp**  
*Professor Teacher Education*

Anne Tapp is a Professor in the Department of Teacher Education at SVSU and serves as a Director for the University of Michigan Center for Digital Curricula. She is a Board of Directors executive committee member for the American Association for Colleges of Teacher Education, chairs the AACTE Advisory Council of State Representatives Executive Committee, and is the Past President of the Michigan Association of Colleges for Teacher Education. She is the author of several publications including *Technology in the Early Classroom*, and is currently on sabbatical as the Executive in Residence for NASA JPL Education.



**Peggy Mead-Finizio**  
*Associate Professor of Theatre*



Peggy is in her eighth year at Saginaw Valley State University. She is an active theatre designer, technical theatre instructor, choreographer, dance instructor, director, and arts administrator. She designs lights and sound for some SVSU mainstage productions and is a mentor to SVSU student theatre designers and technicians. She holds MFA degrees in Theatre Arts and Choreography from the University of Iowa and is a certified teacher Primary - Level 3 of the ABT (American Ballet Theatre) National Training Curriculum. She is currently serving as a Co-Vice Chair of the Design, Technology, and Management program of the Region 3 Kennedy Center American College Theatre Festival where she plays an integral part in planning and implementation of activities and events for the annual festival.

## The Study Abroad Faculty Learning Community

*The Study Abroad Faculty Learning Community is exploring the connections between study abroad and experiential learning. The FLC members, with the help of the Study Abroad office, are developing best practices for the most impactful study abroad experiences.*

### **Shaun Bangert** *Professor of Art*

Shaun Bangert is a Professor of Art and Chair of the Art Department at SVSU. She has a BFA from Siena Heights University, and an MFA from the University of Michigan. She presently teaches courses in Graphic Design and Art History.



### **Gary Lange** *Professor of Biology*

Gary Lange is a Professor in the Department of Biology. He has been a member of the Department for 27+ years. He specializes in Developmental Neuroendocrinology. His research explores the effects of endocrine disrupting pollutants in the environment on the growth, development, and physiology of organisms.



### **Arthur Martin** *Professor of Biology*

Since joining SVSU in 2008, Art Martin has mentored scores of students in Saginaw Bay watershed projects focused on his area of specialization: aquatic ecology. In addition to his many research grants, Art has also received CETL grants to develop active-learning and project-based laboratories and to incorporate evidence-based best teaching practices across the biology curriculum.





***Sylvia Fromherz Sharp***  
*Associate Professor of Biology*

Sylvia Fromherz, Associate Professor, Biology (since 2015) is a cell and molecular biologist with lifelong sweet spots for marine biology, the Oregon coast, and anything outdoors. She is also a big fan of study abroad opportunities for undergraduates, having studied in Germany for a year on such a program.

***Marilyn Skrocki***  
*Professor of Health Sciences*

Marilyn Skrocki is Professor in Health Sciences & Graduate Program Coordinator for the Master of Science Health Administration and Leadership program. Marilyn holds master's degrees in business and information systems management, earning Advanced Studies Certificate in Information Security & Networking Management and a Certificate in Management Tools & Techniques.



***Danilo Sirias***  
*Professor of Management*



Danilo Sirias has a master's degree in Industrial and Systems Engineering and a Ph.D. in Business Administration from The University of Memphis. He is currently a Professor in the Department of Management and Marketing at Saginaw Valley State University. Dr. Sirias' research interests include how the Theory of Constraints can improve patient flow in Emergency Departments, Inpatient Units, Operating Rooms, and Outpatient Clinics.

**Robert Kelch**  
*Assistant Professor of Nursing*

Robert Kelch is an Assistant Professor of Nursing, having joined SVSU full-time in July 2019. After a 22 year career as a chemical engineer, Rob started a second career in Nursing by earning a BSN and MSN as a Family Nurse Practitioner from SVSU then a DNP from U of M - Flint. He was a SVSU Adjunct Instructor during the 9 years preceding his full-time appointment. He has participated in 3 SVSU Nursing Study Abroad trips as a student and faculty member and will be leading a Nursing BSN team to Tanzania in May 2023.



**Warren Fincher**  
*Professor of Sociology*

Warren Fincher is an Associate Professor of Sociology who also teaches in Gender Studies, Leadership & Service, and the Honors program. He emphasizes experiential learning in his classes with real-world social research, historical simulations, creative design projects, and study abroad adventures.



**Debbie Lively**  
*Professor Teacher Education*

Dr. Debra Lively is a Professor and Department Chair of the Teacher Education Program at SVSU. Her areas of expertise include early childhood and special education, specifically the education for the deaf and hard of hearing. She received her Ph.D. in Special Education with a cognate in Educational Administration from MSU. Before coming to Saginaw Valley State University, Dr. Lively spent 29 years in public education. Currently, Dr. Lively serves as SVSU's Early Childhood Liaison with Changchun Normal University, Changchun, China. This partnership program provides curriculum and instruction to approximately 300-400 Chinese early childhood candidates.



# Open Education Resource (OER) Grant Recipients

*Funding for these programs was provided by a Strengthening Institutions Program, Title III, from the U. S. Department of Education awarded to Saginaw Valley State University, 2017-2022.*



***Evelyn Ravuri***

*Professor of Geography*

World Cultural/Regional Geogaphy

***Julie Foss***

*Professor of Modern Foreign Languages*

Intermediate French



***Nameeta Mathur***

*Professor of History*

Global Cultures



***Helen Raica-Klotz***

*Lecturer of English*

Literary Terms Guide for General Education Literature





**Joshua Mike**

*Assistant Professor of Mathematical Science*

Calculus

**Kellie Konsor**

*Associate Professor of Economics*

Intro to Economics



**Monika Dix**

*Professor of Modern Foreign Languages*

Studies in World Literature

Intermediate Japanese



**Kavindya Senanayake**

*Assistant Professor of Physics*

General Physics II



# How CETL Supports Faculty

## Teaching

- Online Course Design
- 1-on-1 Consultations
- Course Design
- Best Practices

## Scholarly & Creative Activities (SOTL)

SOTL is a scholarly inquiry into student learning which advances the practice of teaching by making inquiry findings public

## Faculty Learning Communities

Facilitate discussions, lead workshops, & present/share innovative ideas

## Funding Opportunities that Support all Three Areas

- Dow Professor Awards
- Department Innovation Awards
- Faculty Learning Communities



# Grant Funding Opportunities

*The Center for Excellence in Teaching and Learning offers several funding opportunities to support innovations in teaching and learning.*

## **Dow Professor Grants**

Funded by the Herbert H. and Grace A. Dow foundation, these grants provide funding for innovative teaching projects to support thoughtful pedagogical experimentation. The grants support the work of individual tenure-track faculty and teams of faculty for academic and pedagogical innovation projects that enhance student learning. Up to 6 projects will be funded for up to \$5,500 per project. Applications are due by March 15th, 4:30 p.m.

## **Department Innovation Grants**

The purpose of these grants is to support innovative department projects that will improve teaching or other department practices related to student learning and success. The project should be tied to an area of need identified in a recent seven-year review, accreditation report, or annual departmental planning report. Up to two awards are provided for \$5,000 each. Applications are due by March 15th, 4:30 p.m.

## **Faculty Learning Communities**

Sponsored by the Herbert H. and Grace A. Dow Foundation, CETL will support several faculty learning communities (FLC) in the 2023-2024 academic year. The FLCs will focus on "Emerging Technologies and Their Implications for Higher Education." Each community member will develop a project designed to move the campus community forward in adapting to these emerging technologies. FLC participation is open to all full-time faculty. Applications are due by March 15th, 4:30 p.m.

## **Rural Pathways Faculty Learning Communities Grants**

These grants support department-based faculty learning communities in the development and implementation of best practices related to a course revision or other pedagogical innovation that will enhance rural student access, retention, and success. Pedagogical changes could include, but are not limited to, adopting early and frequent low-stakes assessments across all sections, standardizing assessments, revising grading practices, developing active learning teaching methods, leveraging supplemental instruction, developing online sections of important courses, developing courses that could be taught out of rural high schools, or making courses more affordable through the incorporation of Open Educational Resources. Priority will be given to departments seeking to make changes to the classroom experience in a high-enrollment first-year course (or sequenced courses). Application deadline to be announced soon.

Z 231  
(989) 964-2622  
CETL@svsu.edu  
[www.svsu.edu/CETL](http://www.svsu.edu/CETL)

